



Building Great Places

Development Update - Infrastructure, amenities and facilities at Ludlow Green, Ludlow

We take pride in what we do and work hard to deliver developments our customers will enjoy living in.

As well as building high quality homes, our developments are designed to include the necessary infrastructure, useful amenities, leisure facilities and green open spaces.

The table below gives details of the works which are in progress and are planned to be/will be delivered at Ludlow Grange, Ludlow. The works are also shown on the plan below.

The timescales provided for completion of works are indicative and may be subject to change based on external market factors.

For information on progress of these works please check the Development website accessed via www.crestnicholson.com

Schedule of Remaining Works to Parcel

Plan Ref	Description	Remaining Works	Is a Third Party Responsible for Completing?	Forecast Date for Works Completion
1	Adoptable Road	<ul style="list-style-type: none"> Complete final surfacing 	NO	Q4 27
2	Adoptable Road	<ul style="list-style-type: none"> Complete final surfacing 	NO	Q2 25
3	Adoptable Road	<ul style="list-style-type: none"> Complete final surfacing 	NO	Q4 27
4	Adoptable Road	<ul style="list-style-type: none"> Complete final surfacing 	NO	Q4 25
5	Adoptable Road	<ul style="list-style-type: none"> Complete final surfacing 	NO	Q4 25
6	Adoptable Road	<ul style="list-style-type: none"> Complete final surfacing 	NO	Q4 27
7	Adoptable Road	<ul style="list-style-type: none"> Complete soft landscape works 	NO	Q2 27
8	Adoptable Road	<ul style="list-style-type: none"> Complete soft landscaping 	NO	Q2 27
9	Adoptable Road	<ul style="list-style-type: none"> Complete soft landscaping 	NO	Q4 27
10	Private Road	<ul style="list-style-type: none"> Complete final surfacing 	NO	COMPLETE
11	Private Road	<ul style="list-style-type: none"> Complete final surfacing 	NO	COMPLETE
12	Private Road	<ul style="list-style-type: none"> Complete final surfacing 	NO	COMPLETE

March 2025 – Updated Quarterly



Building Great Places

Development Update - Infrastructure, amenities and facilities at Ludlow Green, Ludlow

13	Private Road	<ul style="list-style-type: none"> Complete final surfacing 	NO	COMPLETE
14	Private Road	<ul style="list-style-type: none"> Complete soft landscape works 	NO	Q3 25
15	Private Road	<ul style="list-style-type: none"> Complete works 	NO	Q4 25
16	Private Road	<ul style="list-style-type: none"> Complete final surfacing 	NO	Q4 27
17	Private Road	<ul style="list-style-type: none"> Complete final surfacing 	NO	Q4 27
18	Private Road	<ul style="list-style-type: none"> Complete final surfacing 	NO	Q4 27
19	Private Road	<ul style="list-style-type: none"> Complete final surfacing 	NO	Q4 27
20	Private Road	<ul style="list-style-type: none"> Complete final surfacing 	NO	Q4 27
21	Private Road	<ul style="list-style-type: none"> Complete final surfacing 	NO	Q4 27
22	Private Road	<ul style="list-style-type: none"> Complete final surfacing 	NO	Q4 27
23	Private Road	<ul style="list-style-type: none"> Complete final surfacing 	NO	Q4 27
24	Private Parking Court	<ul style="list-style-type: none"> Complete final surfacing 	NO	Q3 25
25	Private Parking Court	<ul style="list-style-type: none"> Complete final surfacing 	NO	Q3 25
26	Private Parking Court	<ul style="list-style-type: none"> Complete final surfacing 	NO	Q4 25
27	Private Parking Court	<ul style="list-style-type: none"> Complete final surfacing 	NO	Q1 27
28	Private Parking Court	<ul style="list-style-type: none"> Complete final surfacing 	NO	Q1 27
29	Private Parking Court	<ul style="list-style-type: none"> Complete final surfacing 	NO	Q1 27
30	Footpath Link	<ul style="list-style-type: none"> Complete final surfacing 	NO	Q4 24
31	Public Open Space	<ul style="list-style-type: none"> Complete Soft Landscaping 	NO	Q1 25



Building Great Places

Development Update - Infrastructure, amenities and facilities at Ludlow Green, Ludlow

32	Public Open Space	<ul style="list-style-type: none"> Complete Soft Landscaping 	NO	Q4 27
33	Public Open Space	<ul style="list-style-type: none"> Complete Soft Landscaping 	NO	Q4 27
34	Public Open Space	<ul style="list-style-type: none"> Complete Soft Landscaping 	NO	Q4 25
35	Public Open Space	<ul style="list-style-type: none"> Complete Soft Landscaping 	NO	Q4 25
36	Public Open Space	<ul style="list-style-type: none"> Complete Soft Landscaping 	NO	Q4 27
37	Public Open Space	<ul style="list-style-type: none"> Complete Soft Landscaping 	NO	Q4 27
38	Public Open Space	<ul style="list-style-type: none"> Complete Soft Landscaping 	NO	Q4 27
39	Public Open Space	<ul style="list-style-type: none"> Complete Soft Landscaping 	NO	Q4 27
40	Play Area	<ul style="list-style-type: none"> Complete Works 	NO	Q4 27
41	Drainage Basin	<ul style="list-style-type: none"> Complete Soft Landscaping 	NO	COMPLETE
42	Drainage Basin	<ul style="list-style-type: none"> Complete Soft Landscaping 	NO	Q3 25
43	Drainage Basin	<ul style="list-style-type: none"> Complete Soft Landscaping 	NO	Q4 25
44	Drainage Basin	<ul style="list-style-type: none"> Complete Soft Landscaping 	NO	Q4 27
45	Drainage Basin	<ul style="list-style-type: none"> Complete Soft Landscaping 	NO	Q2 25
46	Drainage Basin	<ul style="list-style-type: none"> Complete Soft Landscaping 	NO	Q1 27
47	Drainage Basin	<ul style="list-style-type: none"> Complete Soft Landscaping 	NO	Q1 27
48	Drainage Basin	<ul style="list-style-type: none"> Complete Soft Landscaping 	NO	Q1 27
49	Pumping Station	<ul style="list-style-type: none"> Complete Pumping station 	NO	Q3 25
50	Pumping Station	<ul style="list-style-type: none"> Complete Pumping station 	NO	Q2 26



Building Great Places

Development Update - Infrastructure, amenities and facilities at Ludlow Green, Ludlow

Notes:

- The estate management company will also be responsible for maintaining small areas of incidental landscaping for a small number of properties. These items are not included on the above schedule due to their more limited nature and use, however they will be completed alongside the adjacent homes.

Building Great Places

Development Update - Infrastructure, amenities and facilities at Ludlow Green, Ludlow

Parcel Remaining Works Plan

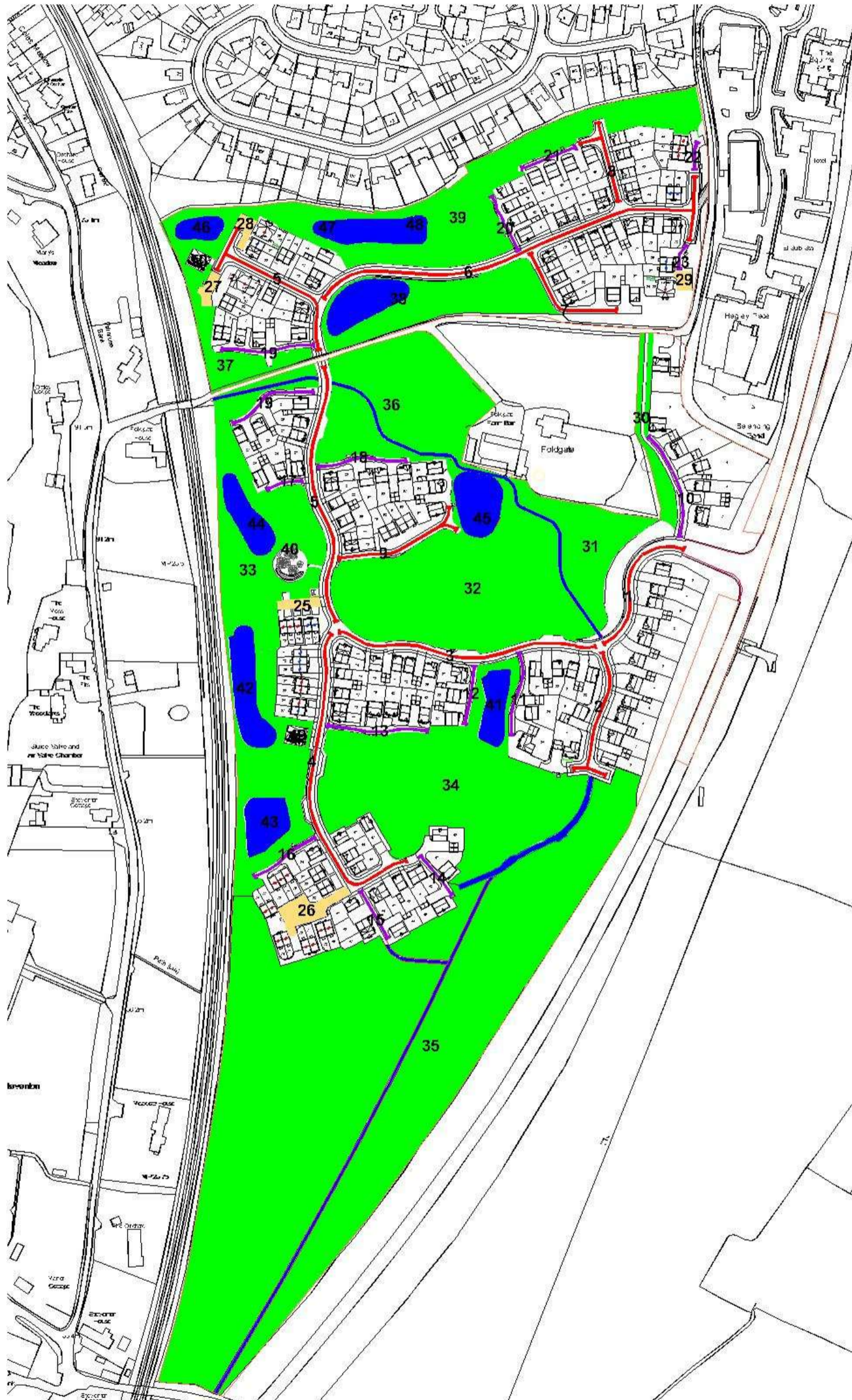



Building Great Places

Development Update - Infrastructure, amenities and facilities at Ludlow Green, Ludlow

Schedule of Remaining Works to Wider Estate

N/A

Wider Estate Remaining Works Plan

N/A



Building Great Places

Development Update - Infrastructure, amenities and facilities at Ludlow Green, Ludlow

Managing Agents Contact Details

Crest Nicholson has appointed **Firstport** to undertake the estate management for the development. Should you wish to discuss any estate management matters please contact the following:

Liz Eastwood - liz.eastwood@firstport.co.uk