

Building Great Places

Development Update - Infrastructure, amenities and facilities at Ludlow Green, Ludlow

We take pride in what we do and work hard to deliver developments our customers will enjoy living in.

As well as building high quality homes, our developments are designed to include the necessary infrastructure, useful amenities, leisure facilities and green open spaces.

The table below gives details of the works which are in progress and are planned to be/will be delivered at Ludlow Grange, Ludlow. The works are also shown on the plan below.

The timescales provided for completion of works are indicative and may be subject to change based on external market factors.

For information on progress of these works please check the Development website accessed via www.crestnicholson.com

Schedule of Remaining Works to Parcel

| Plan Ref | Description | Remaining Works | Is a Third Party Responsible for Completing? | Forecast Date for Works Completion |
|----------|----------------|---|--|------------------------------------|
| 1 | Adoptable Road | <ul style="list-style-type: none"> Complete final surfacing | NO | Q4 27 |
| 2 | Adoptable Road | <ul style="list-style-type: none"> Complete final surfacing | NO | Q2 25 |
| 3 | Adoptable Road | <ul style="list-style-type: none"> Complete final surfacing | NO | Q4 27 |
| 4 | Adoptable Road | <ul style="list-style-type: none"> Complete final surfacing | NO | Q4 25 |
| 5 | Adoptable Road | <ul style="list-style-type: none"> Complete final surfacing | NO | Q4 25 |
| 6 | Adoptable Road | <ul style="list-style-type: none"> Complete final surfacing | NO | Q4 27 |
| 7 | Adoptable Road | <ul style="list-style-type: none"> Complete soft landscape works | NO | Q2 27 |
| 8 | Adoptable Road | <ul style="list-style-type: none"> Complete soft landscaping | NO | Q2 27 |
| 9 | Adoptable Road | <ul style="list-style-type: none"> Complete soft landscaping | NO | Q4 27 |
| 10 | Private Road | <ul style="list-style-type: none"> Complete final surfacing | NO | COMPLETE |
| 11 | Private Road | <ul style="list-style-type: none"> Complete final surfacing | NO | COMPLETE |
| 12 | Private Road | <ul style="list-style-type: none"> Complete final surfacing | NO | COMPLETE |

December 2024 – Updated Quarterly

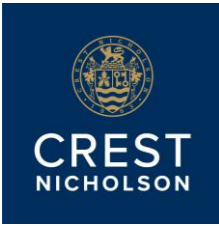

Building Great Places

Development Update - Infrastructure, amenities and facilities at Ludlow Green, Ludlow

| | | | | |
|----|-----------------------|---|----|----------|
| 13 | Private Road | <ul style="list-style-type: none"> Complete final surfacing | NO | COMPLETE |
| 14 | Private Road | <ul style="list-style-type: none"> Complete soft landscape works | NO | Q1 25 |
| 15 | Private Road | <ul style="list-style-type: none"> Complete works | NO | Q4 25 |
| 16 | Private Road | <ul style="list-style-type: none"> Complete final surfacing | NO | Q4 27 |
| 17 | Private Road | <ul style="list-style-type: none"> Complete final surfacing | NO | Q4 27 |
| 18 | Private Road | <ul style="list-style-type: none"> Complete final surfacing | NO | Q4 27 |
| 19 | Private Road | <ul style="list-style-type: none"> Complete final surfacing | NO | Q4 27 |
| 20 | Private Road | <ul style="list-style-type: none"> Complete final surfacing | NO | Q4 27 |
| 21 | Private Road | <ul style="list-style-type: none"> Complete final surfacing | NO | Q4 27 |
| 22 | Private Road | <ul style="list-style-type: none"> Complete final surfacing | NO | Q4 27 |
| 23 | Private Road | <ul style="list-style-type: none"> Complete final surfacing | NO | Q4 27 |
| 24 | Private Parking Court | <ul style="list-style-type: none"> Complete final surfacing | NO | Q3 25 |
| 25 | Private Parking Court | <ul style="list-style-type: none"> Complete final surfacing | NO | Q3 25 |
| 26 | Private Parking Court | <ul style="list-style-type: none"> Complete final surfacing | NO | Q4 25 |
| 27 | Private Parking Court | <ul style="list-style-type: none"> Complete final surfacing | NO | Q1 27 |
| 28 | Private Parking Court | <ul style="list-style-type: none"> Complete final surfacing | NO | Q1 27 |
| 29 | Private Parking Court | <ul style="list-style-type: none"> Complete final surfacing | NO | Q1 27 |
| 30 | Footpath Link | <ul style="list-style-type: none"> Complete final surfacing | NO | Q4 24 |
| 31 | Public Open Space | <ul style="list-style-type: none"> Complete Soft Landscaping | NO | Q1 25 |

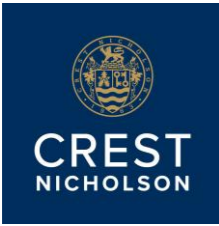

Building Great Places

Development Update - Infrastructure, amenities and facilities at Ludlow Green, Ludlow

| | | | | |
|----|-------------------|---|----|----------|
| 32 | Public Open Space | <ul style="list-style-type: none"> Complete Soft Landscaping | NO | Q4 27 |
| 33 | Public Open Space | <ul style="list-style-type: none"> Complete Soft Landscaping | NO | Q4 27 |
| 34 | Public Open Space | <ul style="list-style-type: none"> Complete Soft Landscaping | NO | Q4 25 |
| 35 | Public Open Space | <ul style="list-style-type: none"> Complete Soft Landscaping | NO | Q4 25 |
| 36 | Public Open Space | <ul style="list-style-type: none"> Complete Soft Landscaping | NO | Q4 27 |
| 37 | Public Open Space | <ul style="list-style-type: none"> Complete Soft Landscaping | NO | Q4 27 |
| 38 | Public Open Space | <ul style="list-style-type: none"> Complete Soft Landscaping | NO | Q4 27 |
| 39 | Public Open Space | <ul style="list-style-type: none"> Complete Soft Landscaping | NO | Q4 27 |
| 40 | Play Area | <ul style="list-style-type: none"> Complete Works | NO | Q4 27 |
| 41 | Drainage Basin | <ul style="list-style-type: none"> Complete Soft Landscaping | NO | COMPLETE |
| 42 | Drainage Basin | <ul style="list-style-type: none"> Complete Soft Landscaping | NO | Q3 25 |
| 43 | Drainage Basin | <ul style="list-style-type: none"> Complete Soft Landscaping | NO | Q4 25 |
| 44 | Drainage Basin | <ul style="list-style-type: none"> Complete Soft Landscaping | NO | Q4 27 |
| 45 | Drainage Basin | <ul style="list-style-type: none"> Complete Soft Landscaping | NO | Q2 25 |
| 46 | Drainage Basin | <ul style="list-style-type: none"> Complete Soft Landscaping | NO | Q1 27 |
| 47 | Drainage Basin | <ul style="list-style-type: none"> Complete Soft Landscaping | NO | Q1 27 |
| 48 | Drainage Basin | <ul style="list-style-type: none"> Complete Soft Landscaping | NO | Q1 27 |
| 49 | Pumping Station | <ul style="list-style-type: none"> Complete Pumping station | NO | Q1 25 |
| 50 | Pumping Station | <ul style="list-style-type: none"> Complete Pumping station | NO | Q2 26 |

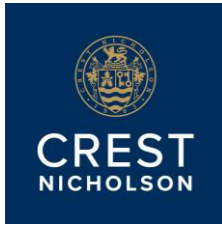

Building Great Places

Development Update - Infrastructure, amenities and facilities at Ludlow Green, Ludlow

Notes:

- The estate management company will also be responsible for maintaining small areas of incidental landscaping for a small number of properties. These items are not included on the above schedule due to their more limited nature and use, however they will be completed alongside the adjacent homes.

Building Great Places

Development Update - Infrastructure, amenities and facilities at Ludlow Green, Ludlow

Parcel Remaining Works Plan

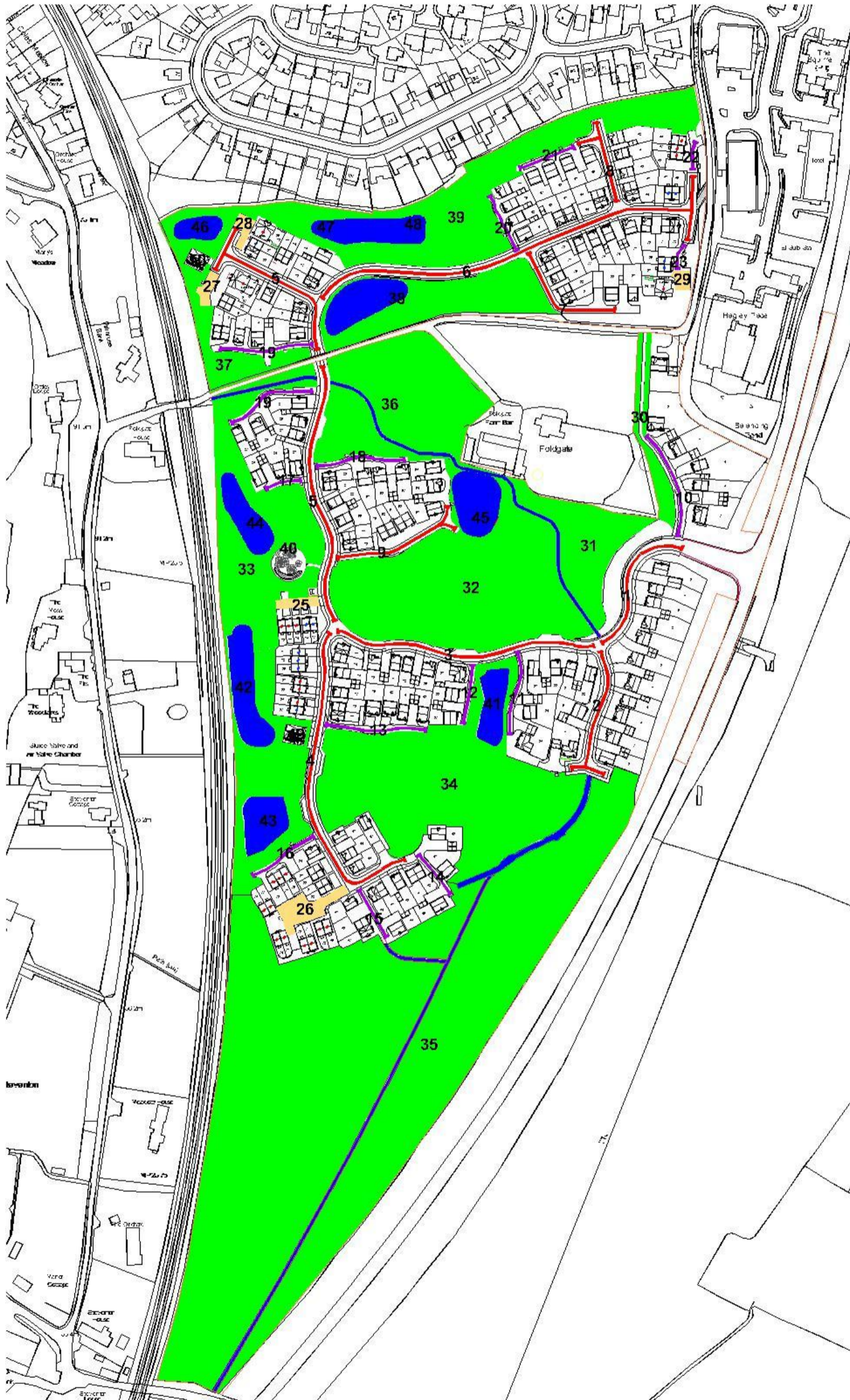



Building Great Places

Development Update - Infrastructure, amenities and facilities at Ludlow Green, Ludlow

Schedule of Remaining Works to Wider Estate

N/A

Wider Estate Remaining Works Plan

N/A



Building Great Places

Development Update - Infrastructure, amenities and facilities at Ludlow Green, Ludlow

Managing Agents Contact Details

Crest Nicholson has appointed Firstport to undertake the estate management for the development. Should you wish to discuss any estate management matters please contact the following:

Liz Eastwood - liz.eastwood@firstport.co.uk