



Building Great Places

Development Update - Infrastructure, amenities, and facilities at Nobel Park, Didcot

We take pride in what we do and work hard to deliver developments our customers will enjoy living in.

As well as building high quality homes, our developments are designed to include the necessary infrastructure, useful amenities, leisure facilities and green open spaces.

The table below gives details of the works which are in progress and will be delivered at Whitehouse Park. The works are also shown on the plan below.

The timescales provided for completion of works are indicative and may be subject to change based on external market factors.

For information on progress of these works please check the Development website accessed via www.crestnicholson.com

Schedule of Remaining Works to Wider Estate

Plan Ref	Description	Remaining Works	Is a Third Party Responsible for Completing?	Forecast Date for Works Completion
1	Croudace Infrastructure	<ul style="list-style-type: none"> Highways and drainage 	Yes	Q3 2025
2	Legal & General Infrastructure	<ul style="list-style-type: none"> Highways and drainage 	Yes	Q3 2026
3	Legal & General Infrastructure	<ul style="list-style-type: none"> Highways and drainage 	Yes	Q2 2026
4	Croudace Homes Development	<ul style="list-style-type: none"> Parcel Works (Phase 2 Croudace Homes) 201 Homes Equipped Play Area 	Yes	Q3 2024
5	Croudace Homes Development	<ul style="list-style-type: none"> Parcel Works (Phase 3 Croudace Homes) 267 Homes 	Yes	Q4 2026



Building Great Places

Development Update - Infrastructure, amenities, and facilities at Nobel Park, Didcot

6	Legal & General Development	<ul style="list-style-type: none"> Parcel Works (Phase 2 Legal & General) 182 Homes Equipped Play Area 	Yes	Q1 2025
7	Crest Nicholson Development	<ul style="list-style-type: none"> Parcel Works Equipped Play Area 	No	Q2 2028
8	Legal & General Development	<ul style="list-style-type: none"> Parcel Works (Phase 4 Legal & General) 110 Homes 	Yes	Q3 2026
9	Legal & General Development	<ul style="list-style-type: none"> Parcel Works (Phase 6 Legal & General) 161 Homes 	Yes	Q1 2033
10	Legal & General Development	<ul style="list-style-type: none"> Parcel Works (Phase 7 Legal & General) 176 Homes Equipped Play Area 	Yes	Q1 2033
11	Legal & General Development	<ul style="list-style-type: none"> Parcel Works (Phase 8 Legal & General) 129 Homes Equipped Play Area 	Yes	Q1 2033
12	Legal & General Development	<ul style="list-style-type: none"> Parcel Works (Phase 9 Legal & General) 143 Homes Equipped Play Area Community Area 	Yes	Q1 20233

Notes:

- The estate management company will also be responsible for maintaining small areas of incidental landscaping and shared drive accesses for a small number of properties. These items are not included on the above schedule due to their more limited nature and use, however they will be completed alongside the adjacent homes.



Building Great Places

Development Update - Infrastructure, amenities, and facilities at Nobel Park, Didcot

Wider Estate Remaining Works Plan

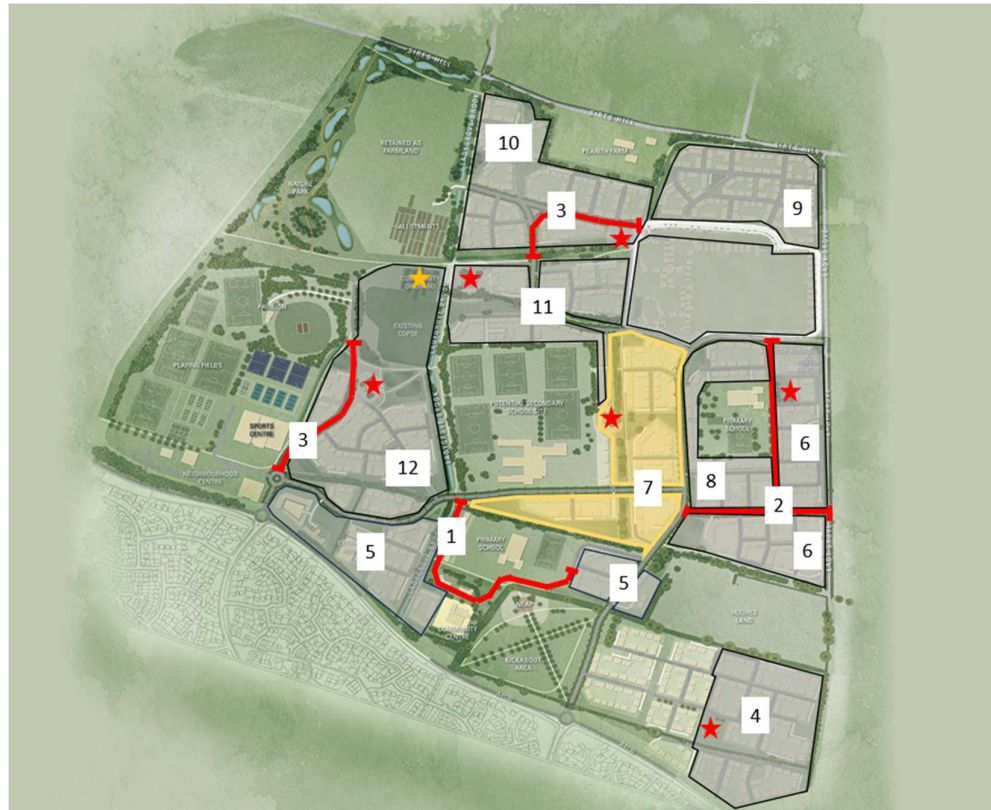

8th November 2024 – Updated Quarterly



Building Great Places

Development Update - Infrastructure, amenities, and facilities at Nobel Park, Didcot

Managing Agents Contact Details

Legal & General, Cala and Crest Nicholson Home have appointed Trinity Estates to undertake the estate management for the development. Should you wish to discuss any estate management matters please contact the following:

Trinity Estates, Vantage Point, 23 Mark Road, Hemel Hempstead, Hertfordshire, HP2 7DN.